

R12664

REASSEMBLY

1. INSTALL BEARING

- (a) Using SST and a press, install a new bearing to the axle carrier.

SST 09527-17011, 09608-32010

NOTICE:

If the inner races come loose from the bearing outer race, be sure to install them on the same side as before.

- (b) Using snap ring pliers, install a new snap ring.

2. INSTALL OIL SEAL (OUTER)

- (a) Using SST and a hammer, install a new oil seal until it is flush with the end surface of axle carrier.

SST 09527-17011, 09608-32010

- (b) Coat MP grease to the oil seal lip.

3. INSTALL BACKING PLATE

Install the backing plate to the axle carrier with the 2 bolts and nuts.

Torque: 59 N·m (600 kgf·cm, 43 ft·lbf)

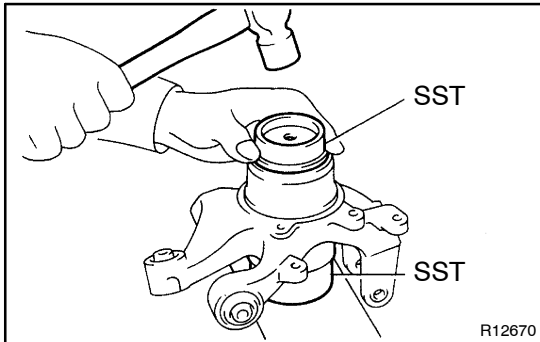

R12670

4. INSTALL AXLE HUB

Using SST and a press, install the axle hub.

SST 09608-32010, 09950-60010 (09951-00430),
09950-70010 (09951-07100)

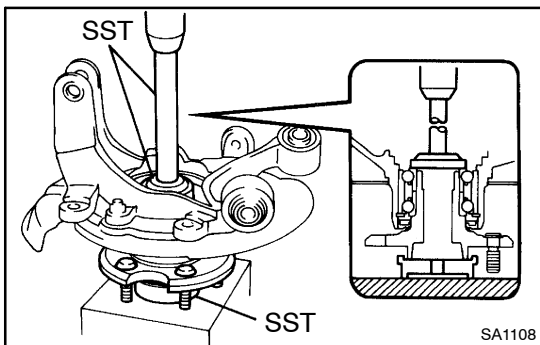

SA1108

5. INSTALL OIL SEAL (INNER)

- (a) Using SST and a hammer, install a new oil seal.

SST 09223-15020, 09608-32010,
09950-70010 (09951-07100)

- (b) Coat MP grease to the oil seal lip.

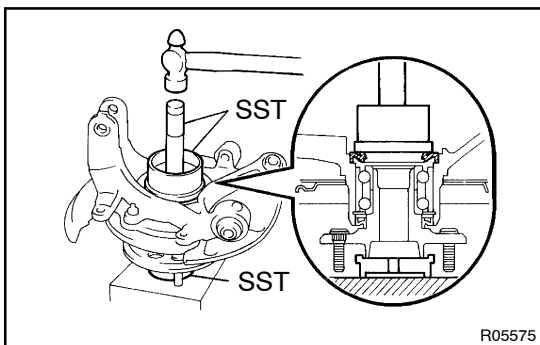

R05575

6. INSTALL DUST DEFLECTOR

Using SST and a press, install a new dust deflector.

SST 09608-32010, 09950-60020 (09951-01030)

HINT:

Align the hole for the ABS speed sensor in the dust deflector with the one in the axle carrier.

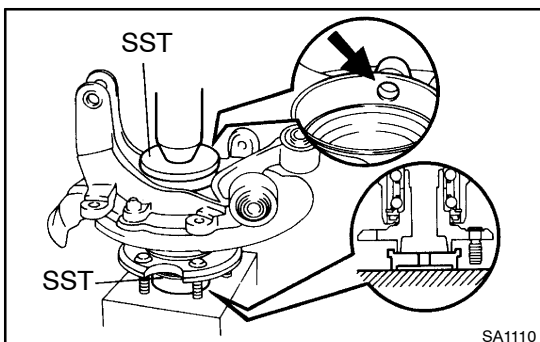

SA1110

7. INSTALL UPPER SUSPENSION ARM

- (a) Install a bolt and 2 nuts to the axle carrier and secure it in a vise.
- (b) Install the upper suspension arm to the axle carrier.
- (c) Install a new nut.

Torque: 108 N·m (1,100 kgf·cm, 80 ft·lbf)