

REAR DOOR OUTER PANEL (ASSY)**REMOVAL**

1. After grinding off the hemming location, remove the outer panel.

INSTALLATION

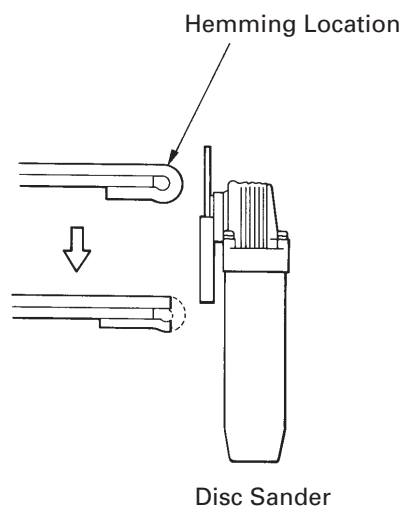
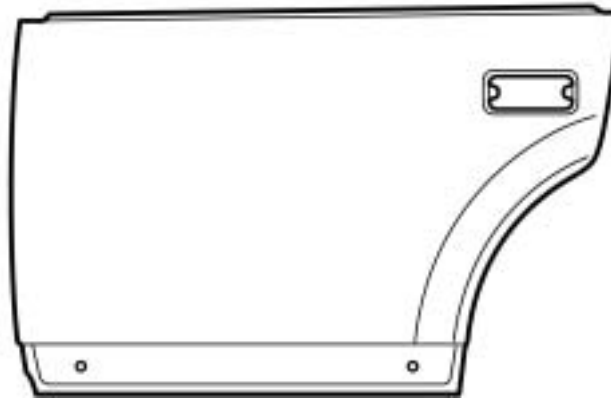
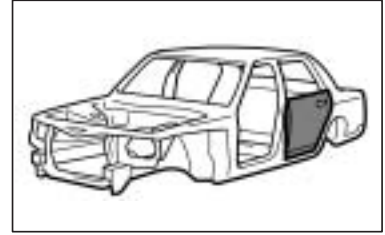
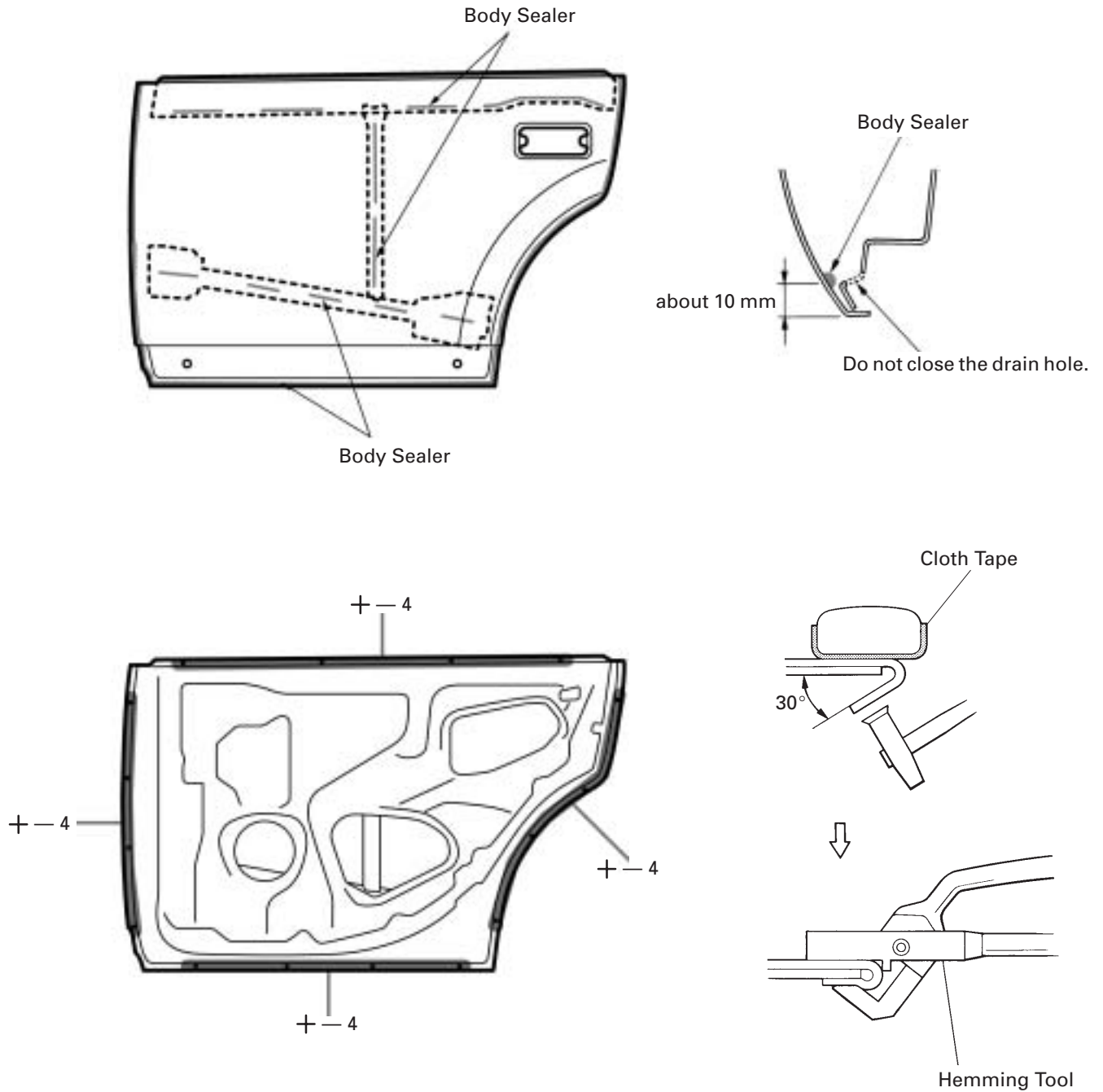

mm	in.
10	0.39

- Before temporarily installing the new parts, apply body sealer to the reinforcement, side impact protection beam and back side of the new parts.
HINT:
1) Apply sealer evenly about 10 mm (0.39 in.) from the flange and 3 mm (0.12 in.) in diameter to the outer panel and apply just enough sealer for the reinforcement and side impact protection beam to make contact.
2) For other sealing points, refer to section AR.
- Bend the flange hem about 30° with a hammer and dolly, then fasten tightly with a hemming tool.
HINT:
1) Perform hemming in three steps, being careful not to warp the panel.
2) If a hemming tool cannot be used, hem with a hammer and dolly.