

## ■ SUB-FRAMES

### 1. Front Sub-Frame

A lightweight and highly rigid front sub-frame made of cast aluminum has been adopted. A reduction in road noise is achieved by mounting the lower arms and the steering gear box directly onto the front sub-frame. A brace is provided between the sub-frame and the strut bar bracket to ensure the sub-frame's longitudinal rigidity while achieving excellent steerability, stability, and riding comfort.

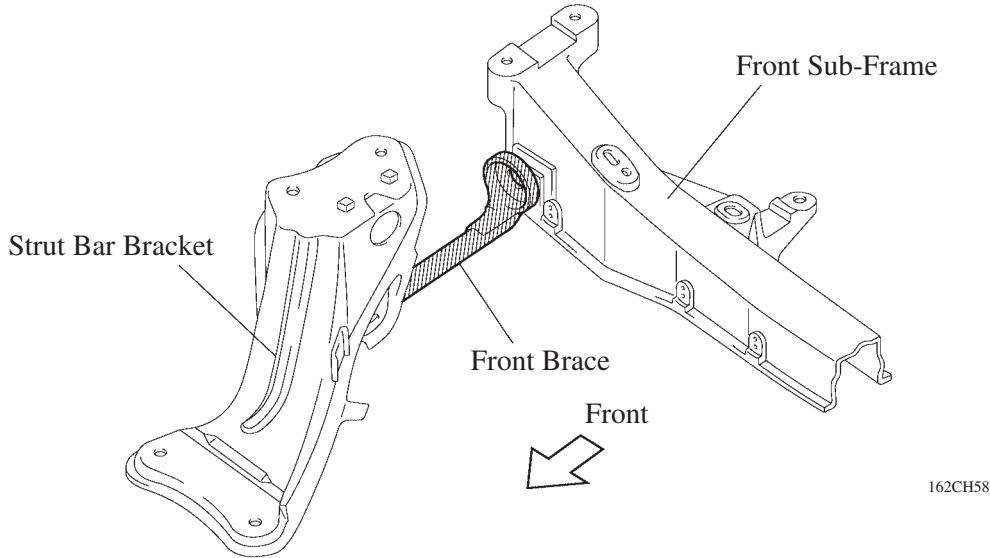

### 2. Rear Sub-Frame

For the rear sub-frame, a pipe frame construction that is lightweight and highly rigid has been adopted. The pipe frame type, which is made by directly combining and welding the pieces of steel pipe materials, achieves weight reduction while ensuring torsional rigidity. A brace is provided between the brackets onto which the No.1 and No.2 lower arms are mounted to ensure high rigidity, thus realizing a smooth and flexible steering feel and flat riding comfort.

