

DISASSEMBLY

1. REMOVE WIRE HARNESS

2. REMOVE AIR DUCT

Remove the 3 screws and the air duct.

3. REMOVE FILTER COVER

- (a) Pull out the air filter.
- (b) Remove the 4 screws and the cover.

4. REMOVE DUCT CASE

Remove the 4 screws and the duct case.

5. REMOVE BLOWER MOTOR

- (a) Disconnect the connector.
- (b) Remove the 3 screws and the blower motor.

6. REMOVE BLOWER RESISTOR

Remove the screw and blower resistor.

7. REMOVE SMOKE SENSOR

Remove the screw and the sensor.

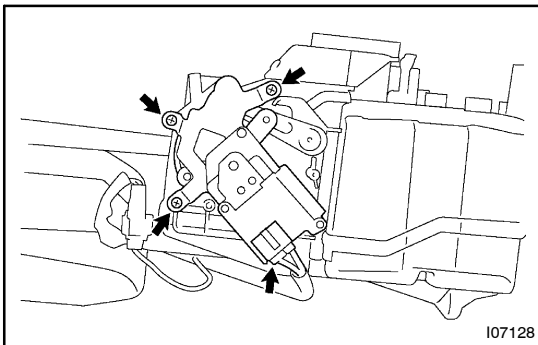

8. REMOVE SERVOMOTOR

- (a) Disconnect the connector.
- (b) Remove the 3 screws and the servomotor.

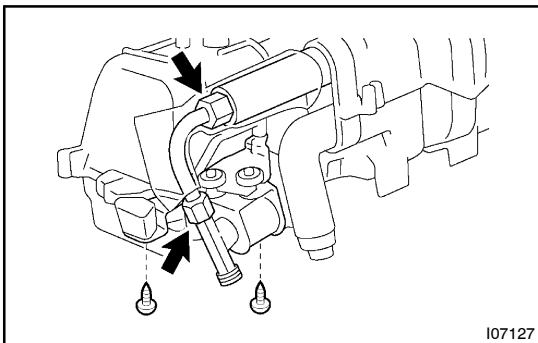

9. REMOVE MAGNETIC VALVE

- (a) Pry out the packing.
- (b) Loosen the 2 nuts and disconnect the liquid tube.

Torque: 14 N·m (140 kgf·cm, 10 ft·lbf)

HINT:

At the time of reassembly, please refer to the following item. Lubricate 2 new O-rings with compressor oil and install them to the tubes.

- (c) Remove the 2 screws and magnetic valve.

10. REMOVE EVAPORATOR

- (a) Remove the 8 screws and separate the upper and lower unit cases.
- (b) Remove the insulator and the evaporator.