

DISASSEMBLY

1. **REMOVE SHIFT LEVER KNOB AND SHIFT LEVER KNOB COVER NO. 1**
2. **REMOVE SHIFT POSITION INDICATOR HOUSING**
 - (a) Remove the shift position indicator housing.
 - (b) Remove the shift lock release button from the shift position indicator housing.
 - (c) Remove the pattern select from the shift position indicator housing.
3. **REMOVE INDICATOR LIGHT WIRE**
 - (a) Remove the indicator light wire from the position indicator light cover.
 - (b) Remove the bulb and cap from the indicator light wire.

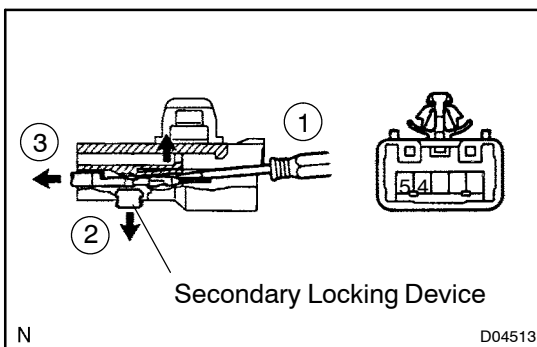

- (c) Remove the connector of transmission control switch from the shift lever plate.
- (d) Disengage the secondary locking device.
- (e) Release the locking lug of the terminals 4 and 5, and pull the terminals out from the rearward.
4. **REMOVE POSITION INDICATOR LIGHT COVER, POSITION INDICATOR SLIDE COVER AND POSITION INDICATOR SLIDE COVER NO. 2**
5. **REMOVE SHIFT LEVER GUIDE HOUSING**
 - (a) Remove the connector of shift control ECU from the shift lever plate.

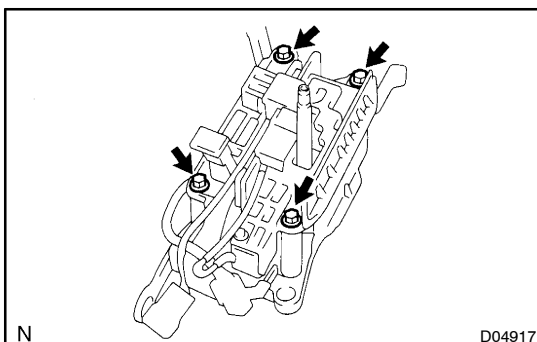

- (b) Remove the 4 bolts and shift lever guide housing.
6. **DISASSEMBLE SHIFT LEVER GUIDE HOUSING**
 - (a) Disconnect the connector of shift lock control switch.
 - (b) Remove the shift lock control ECU.

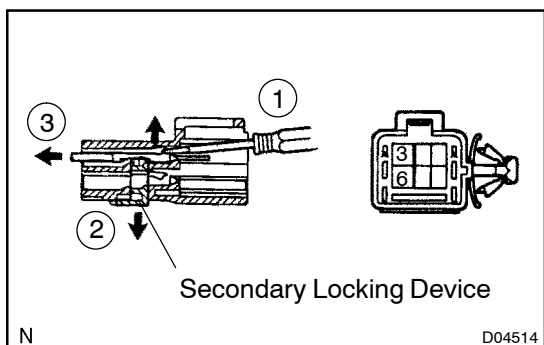

- (c) Disengage the secondary locking device of shift lock control switch.
- (d) Release the locking lug of the terminals 3 and 6, and pull the terminals out from the rearward.
- (e) Remove the shift lock control and transmission control switches.

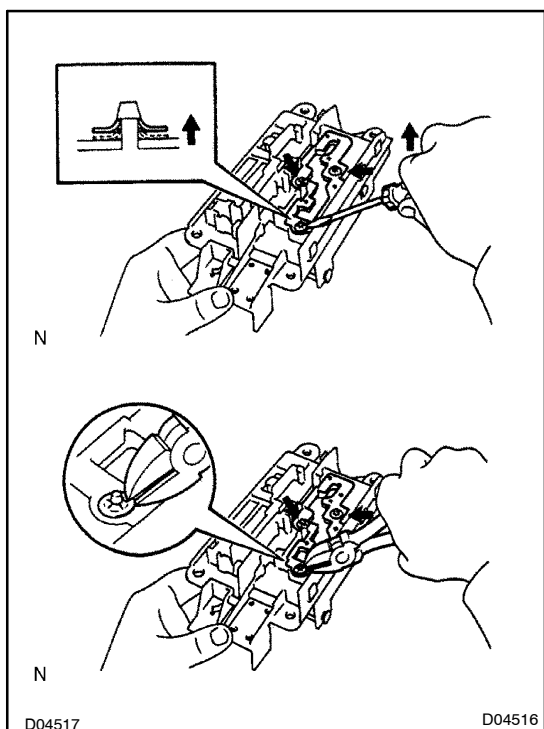

- (f) Using a screwdriver, pry and push up 3 shift lever nuts.
- (g) Using nippers, cut the 3 shift lever nuts off then.

HINT:

Remove the shift lock plate stopper, shift lock release link No. 2 and shift lever plate No. 2 of shift lever nut in the same way.

- (h) Remove the shift lever guide cushion.

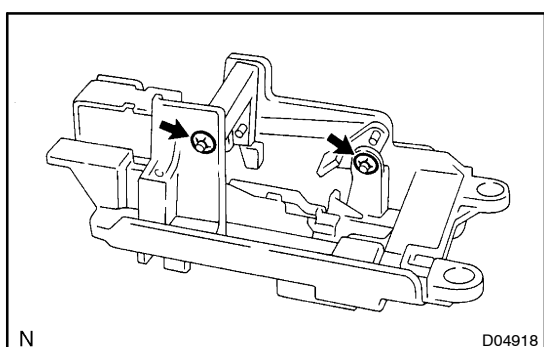

- (i) Remove the 2 shift lever nuts, shift lever lock pin and shift lever lock pin No. 2.

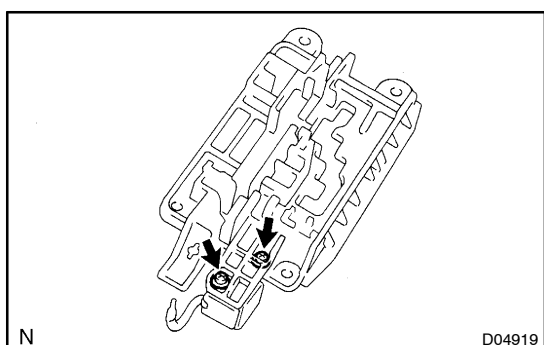

- (j) Remove the 2 screws, shift lock solenoid, spring, shift lock plate stopper, shift lever release link No. 3 and shift lever release link No. 2.

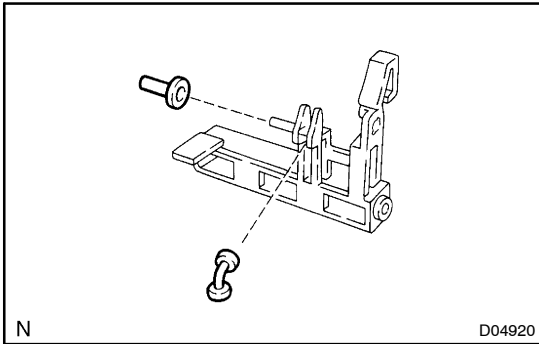

- (k) Remove the bushing and cushion from the shift lock plate stopper.

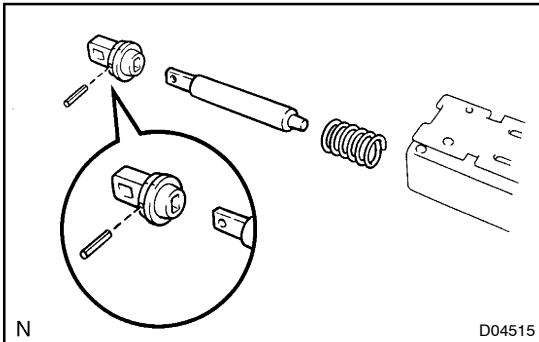

- (l) Using 2-mm dia. steel wire, remove the pin then remove the shift lock solenoid link from the shift lock solenoid plunger.

7. REMOVE SHIFT LEVER SUB-ASSEMBLY

- (a) Remove the shift lever detent rod No. 2 and spring.

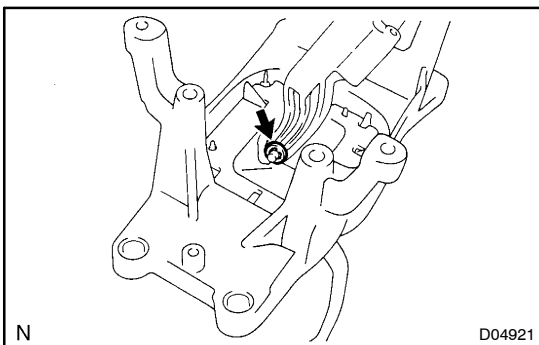

- (b) Using a screwdriver, remove the E-ring and lock pin.
 (c) Remove the shift lever sub-assembly from the shift control shaft assembly.

8. REMOVE SHIFT LEVER BOOT

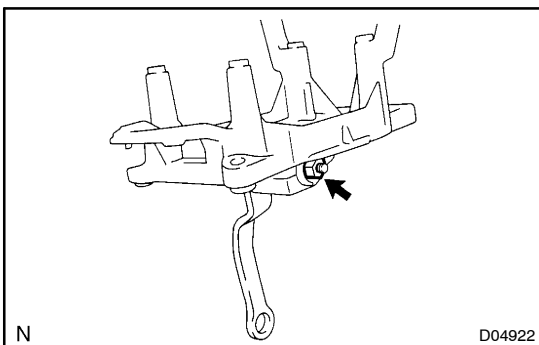

9. REMOVE CONTROL SHAFT SUB-ASSEMBLY

- (a) Remove the nut, washer, 2 spacers, 2 O-rings and control shaft sub-assembly.
 (b) Remove the clip, 2 washers, grommet, bushing and connecting rod swivel.

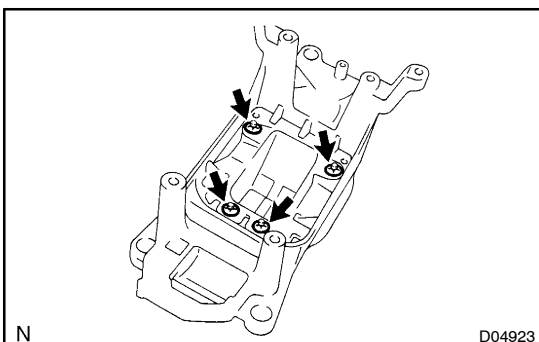

10. REMOVE SHIFT LEVER PLATE NO. 2

- (a) Remove the 4 shift lever nuts.
 (b) Remove the shift lever plate No. 2 and shift lever boot dust seal.

11. REMOVE 4 COLLARS