

DTC	42	Air Inlet Damper Control Servomotor Circuit
------------	-----------	--

CIRCUIT DESCRIPTION

The air inlet damper control servomotor is controlled by the A/C control assembly and moves the air inlet damper to the desired position.

DTC No.	Detection Item	Trouble Area
42	Air inlet damper position sensor value does not change even if A/C control assembly operated air inlet damper control servomotor.	<ul style="list-style-type: none"> • Air inlet damper position sensor. • Harness or connector between air inlet damper control servomotor assembly and A/C control assembly. • A/C control assembly.

WIRING DIAGRAM

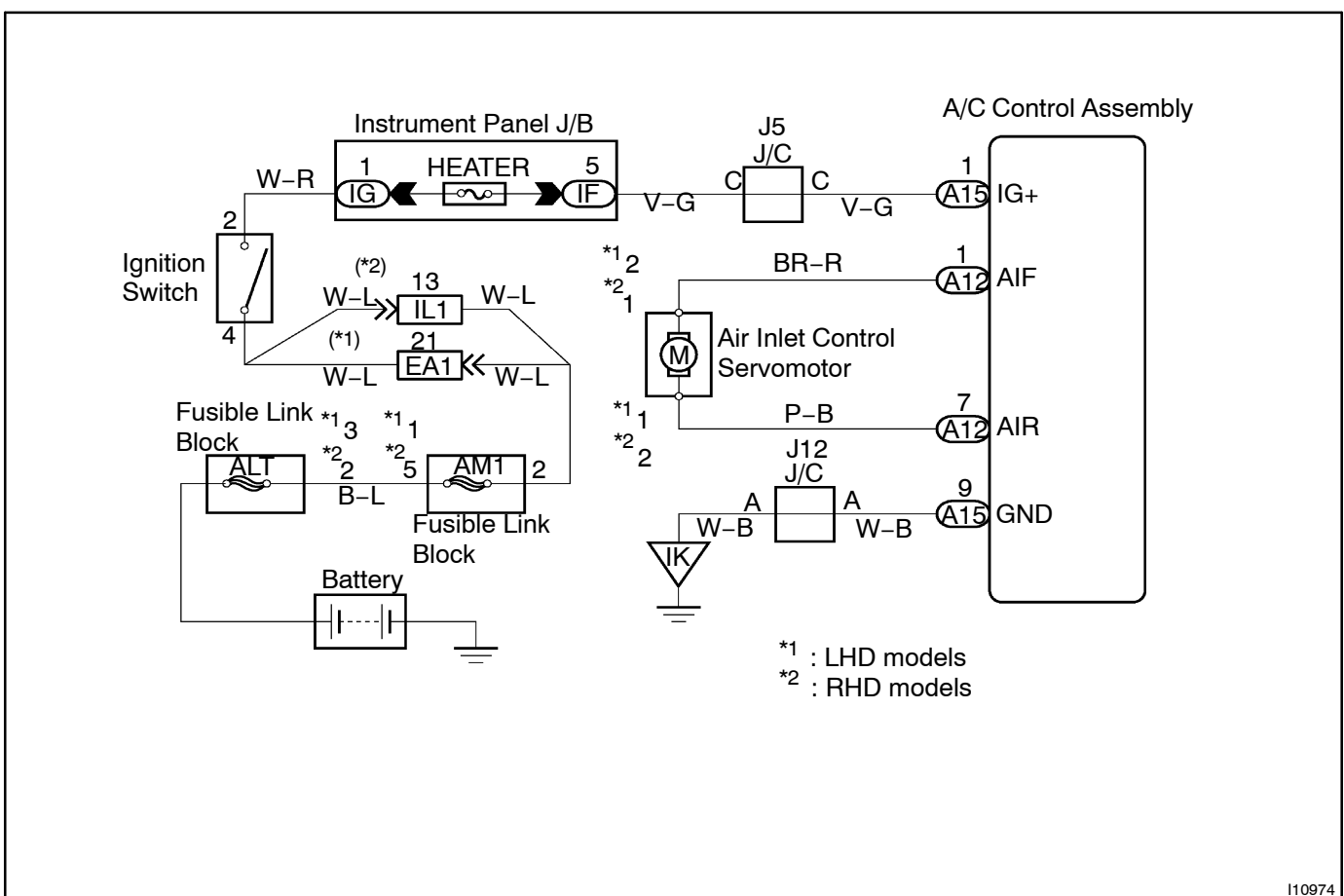

INSPECTION PROCEDURE

1 Actuator check.

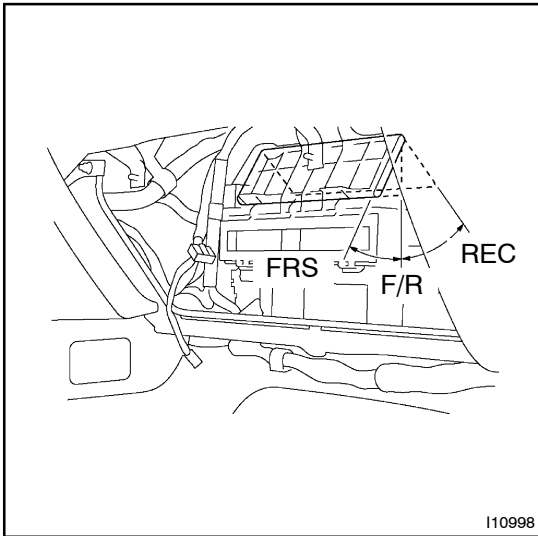
**PREPARATION:**

- Remove the No.2 under cover.
- Remove the glove compartment door.
- Remove the CD changer assembly.
- Set to the actuator check mode (See page DI-768).
- Press the UP switch and change it to step operation.

CHECK:

Press the UP switch in order and check the operation of air inlet damper.

OK:

Display Code	Air Inlet Damper
0 -	FRS
2	F/R
3	REC
4 -	FRS

OK

Proceed to next circuit inspection shown on problem symptoms table (See page DI-780).

OK

2 Check air inlet damper control servomotor.

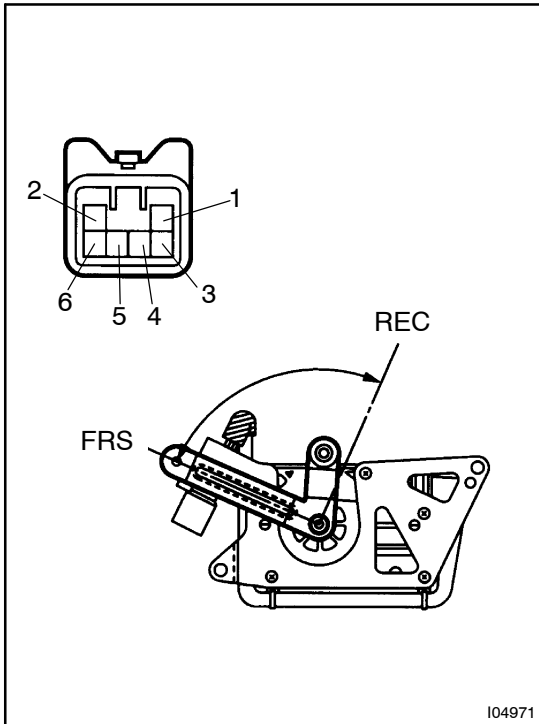

PREPARATION:

Remove air inlet damper control servomotor (See page AC-44).

CHECK:

Connect positive (+) lead to terminal 1 (2) and negative (-) lead to terminal 2 (1).

(): RHD models

OK:

The lever moves smoothly to REC position.

CHECK:

Connect negative (-) lead to terminal 1 (2) and positive (+) lead to terminal 2 (1).

(): RHD models

OK:

The lever moves smoothly to FRS position.

NG

Replace air inlet damper control servomotor assembly.

OK

3 Check harness and connector between A/C control assembly and air inlet damper control servomotor assembly (See page IN-30).

NG

Repair or replace harness or connector.

OK

Check and replace A/C control assembly.