

REMOVAL

1. REMOVE REAR WHEEL
2. REMOVE EXHAUST TAILPIPE
 - (a) Remove the 2 tailpipe support rings.

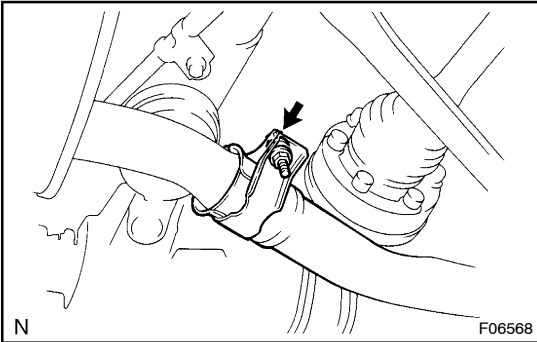

- (b) Loosen the bolt and remove the tailpipe.

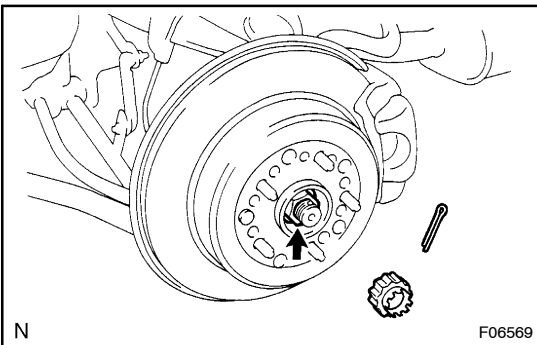

3. REMOVE DRIVE SHAFT LOCK NUT
 - (a) Remove the cotter pin and lock cap.
 - (b) While applying the brakes, remove the nut.

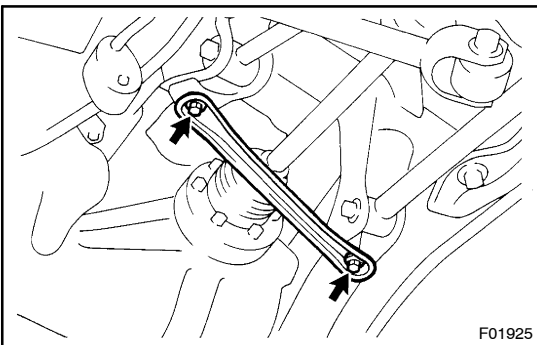

4. REMOVE REAR DRIVE SHAFT
 - (a) Remove the 2 bolts and suspension member brace.

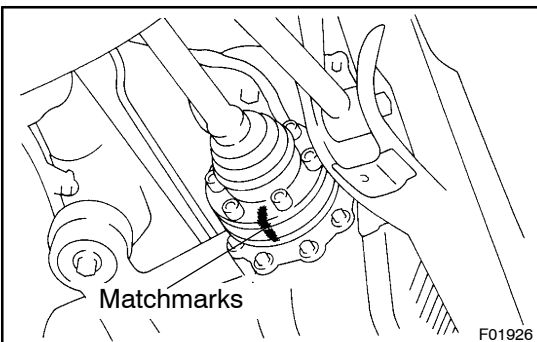

- (b) Place matchmarks on the drive shaft and side gear shaft.
- (c) Using a 10 mm hexagon wrench, remove the 6 hexagon bolts and 2 washers while applying the brakes.
- (d) Disconnect the drive shaft from the side gear shaft.
- (e) Support the drive shaft so that the outboard joint does not bend too much.

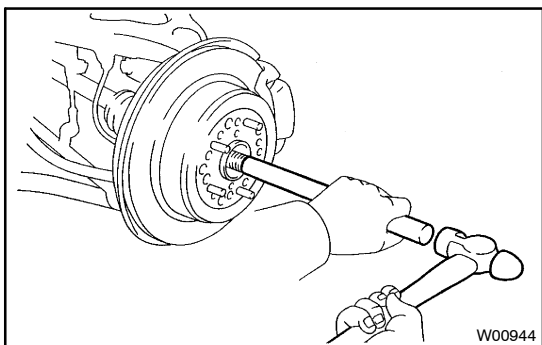

- (f) Using a brass bar and hammer, lightly tap the end of the drive shaft to disengage the axle hub and remove the drive shaft.

NOTICE:

Be careful not to damage the boots, end cover, ABS speed sensor rotor and oil seal.