

REASSEMBLY

1. **INSTALL 4 COLLARS**
2. **INSTALL SHIFT LEVER PLATE NO. 2**
 - (a) Install the shift lever boot dust seal and shift lever plate No. 2.

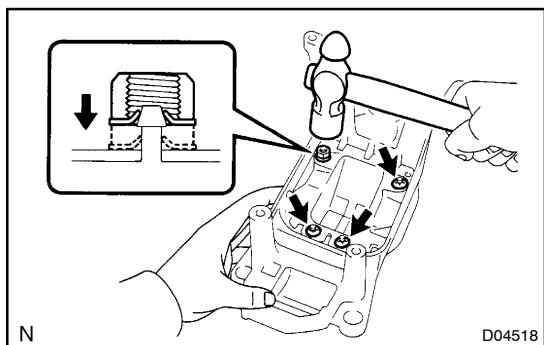

- (b) Install new 4 shift lever nuts to the shift lever plate by knocking them lightly via the 10-mm seated nut.

HINT:

Install the shift lock release link No. 2, shift lock plate stopper and shift lever guide cushion of the shift lever nut in the same way.

3. **INSTALL CONTROL SHAFT SUB-ASSEMBLY**

- (a) Apply MP grease to the connecting rod swivel and shift control shaft sub-assembly.
- (b) Install the connecting rod swivel, bushing, grommet, 2 washers and clip to the control shaft sub-assembly.

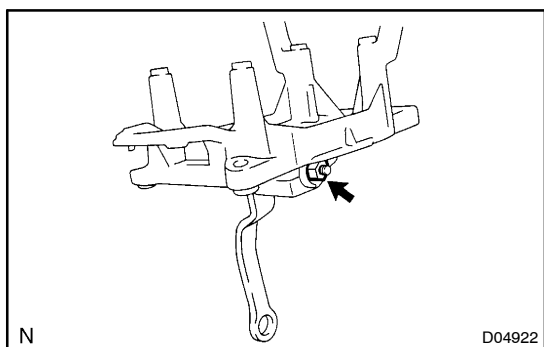

- (c) Install 2 new O-rings, 2 spacers, washer and control shaft sub-assembly with the nut.

Torque: 13 N·m (130 kgf·cm, 9 ft·lbf)

4. **INSTALL SHIFT LEVER BOOT**

5. **INSTALL SHIFT LEVER SUB-ASSEMBLY**

- (a) Install the shift lever sub-assembly to the shift control shaft sub-assembly.
- (b) Apply MP grease to lock pin.

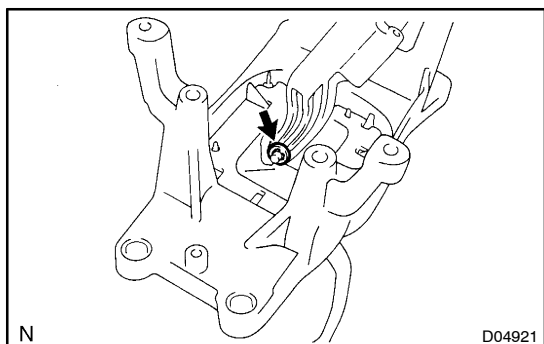

- (c) Install the lock pin and E-ring.
- (d) Apply MP grease to the shift lever detent rod No. 2 and spring.
- (e) Install the spring and shift lever detent rod No. 2 to the shift lever sub-assembly.

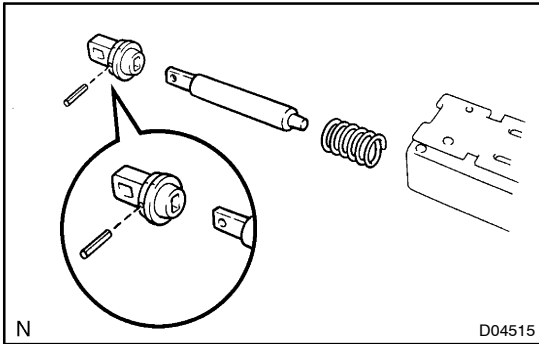
**6. REASSEMBLE SHIFT LEVER GUIDE HOUSING**

- (a) Apply MP grease to the shift lock solenoid link.
- (b) Install the shift lock solenoid link and pin to the shift lock solenoid plunger.
- (c) Install the shift lock solenoid link with shift lock solenoid plunger and spring to the shift lock solenoid.

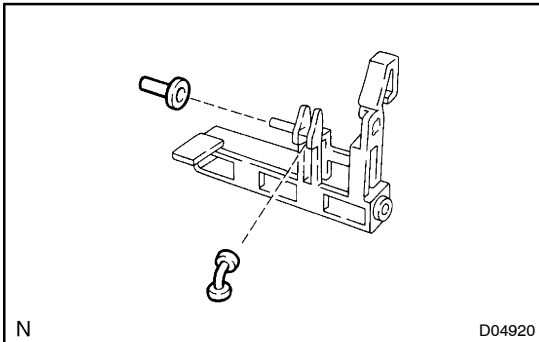

- (d) Install the cushion and bushing to the shift lock plate stopper.
- (e) Apply MP grease to the shift lever release link No. 3.

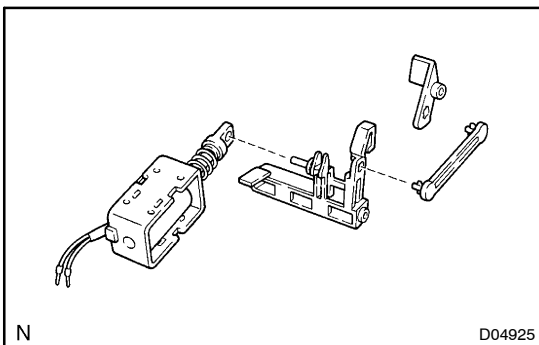

- (f) Install the shift lever release link No. 2, No. 3 and shift lock solenoid to the shift lock plate stopper.
- (g) Apply MP grease to the shift lever lock pin and shift lever lock pin No. 2.
- (h) Install the shift lock plate stopper assembly to the shift lever guide housing.

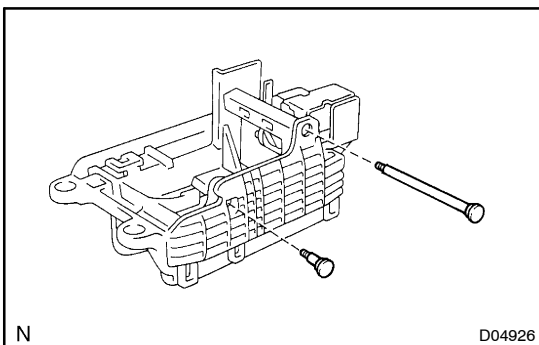

- (i) Install the shift lever lock pin and shift lever lock pin No. 2 with 2 new shift lever nuts.

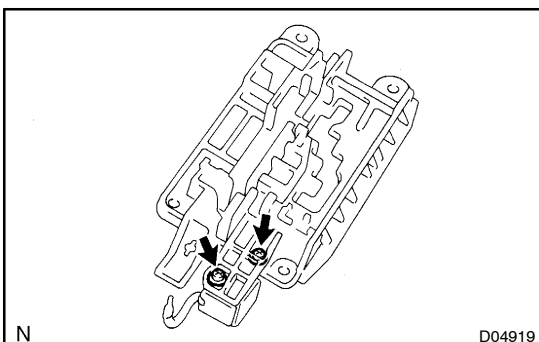

- (j) Install the 2 screws.

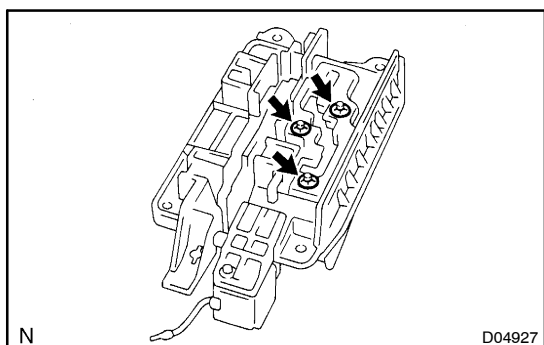

- (k) Install the shift lever guide cushion with new 3 shift lever nuts.
- (l) Install the shift lock control and transmission control switches.
- (m) Connect the 2 shift lock solenoid terminals to the connector of shift lock control connector.
- (n) Install the shift lock control ECU.
- (o) Apply MP grease to the shift lock release link.
- (p) Install the spring and shift lock release link.
- (q) Connect the connector of shift lock control ECU and shift lock control switch.

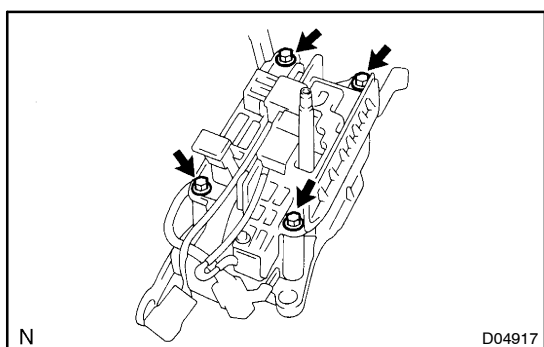

7. INSTALL SHIFT LEVER GUIDE HOUSING

- (a) Install the shift lever guide housing to the shift lever plate with the 4 bolts.

Torque: 4.9 N·m (50 kgf·cm, 43 in·lbf)

- (b) Connect the 2 connectors to the shift lever plate.

8. INSTALL POSITION INDICATOR SLIDE COVER NO. 2, POSITION INDICATOR SLIDE COVER AND POSITION INDICATOR LIGHT WIRE

9. INSTALL INDICATOR LIGHT WIRE

- (a) Connect the 2 indicator light wire terminals to the connector of transmission control switch.
- (b) Install the bulb and cap to the indicator light wire.
- (c) Install the indicator wire to the position indicator light cover.

10. INSTALL SHIFT POSITION INDICATOR HOUSING

- (a) Install the pattern select switch to the shift position indicator housing.
- (b) Install the shift lock release button to the shift position indicator housing.
- (c) Install the shift position indicator housing.

11. INSTALL SHIFT LEVER KNOB COVER NO. 1 AND SHIFT LEVER KNOB