

## QUARTER PANEL (CUT)

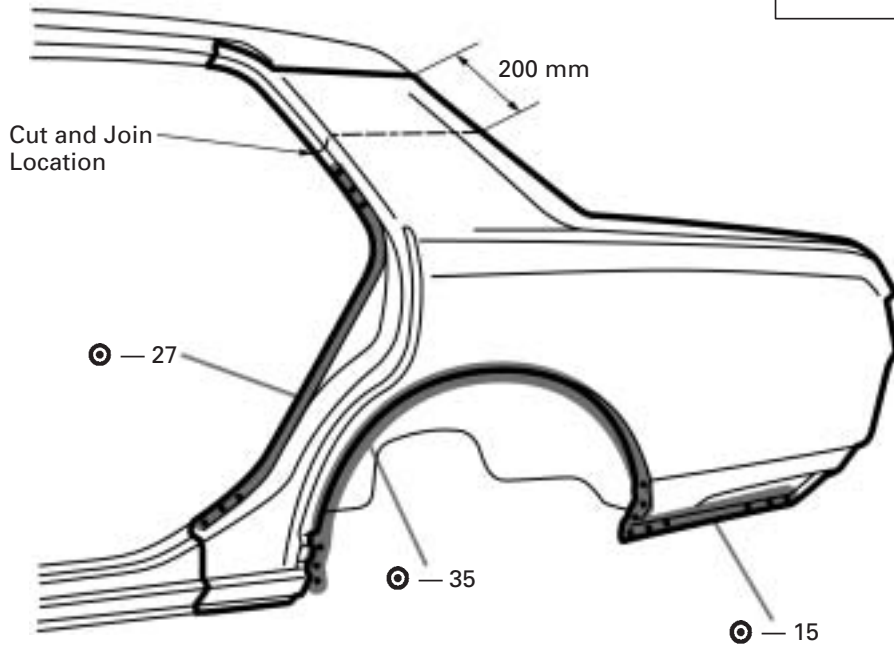

### REMOVAL



[Cut and Join Location]

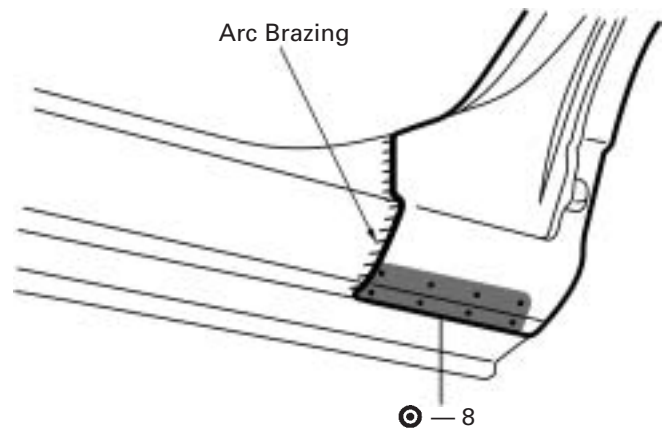

1. Cut and join the parts at the location as shown above.

*HINT: Make incision and bend the roof drip channel at the upper part of the cut and join location.*

mm	in.
200	7.87

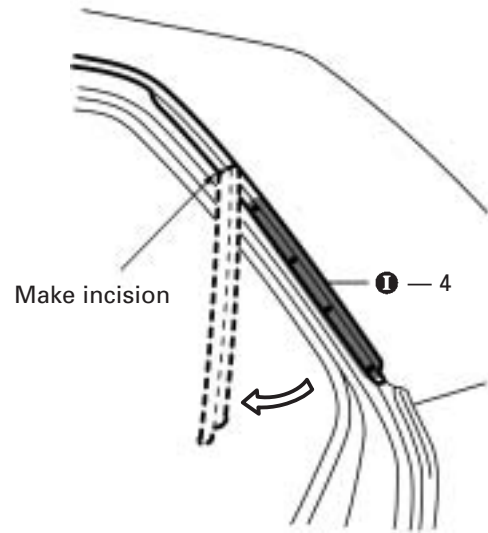
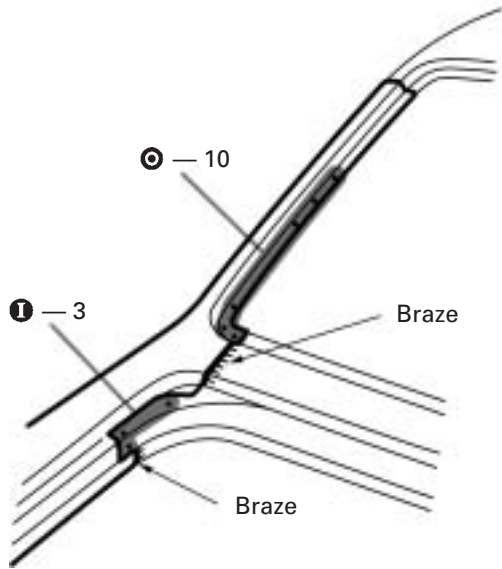

[If replacing the luggage compartment opening trough]

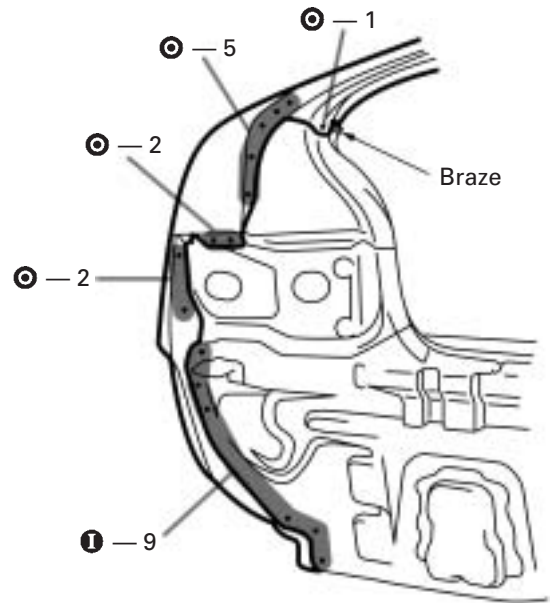
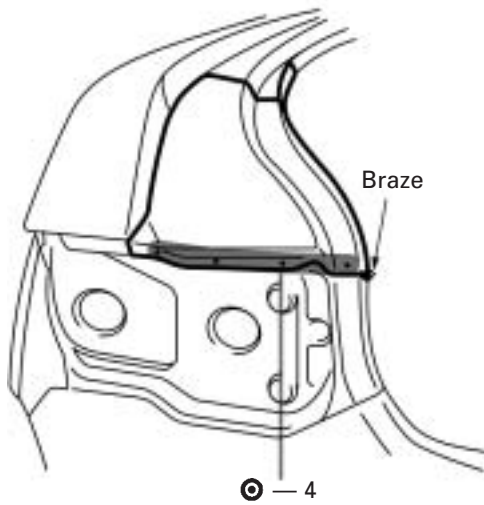

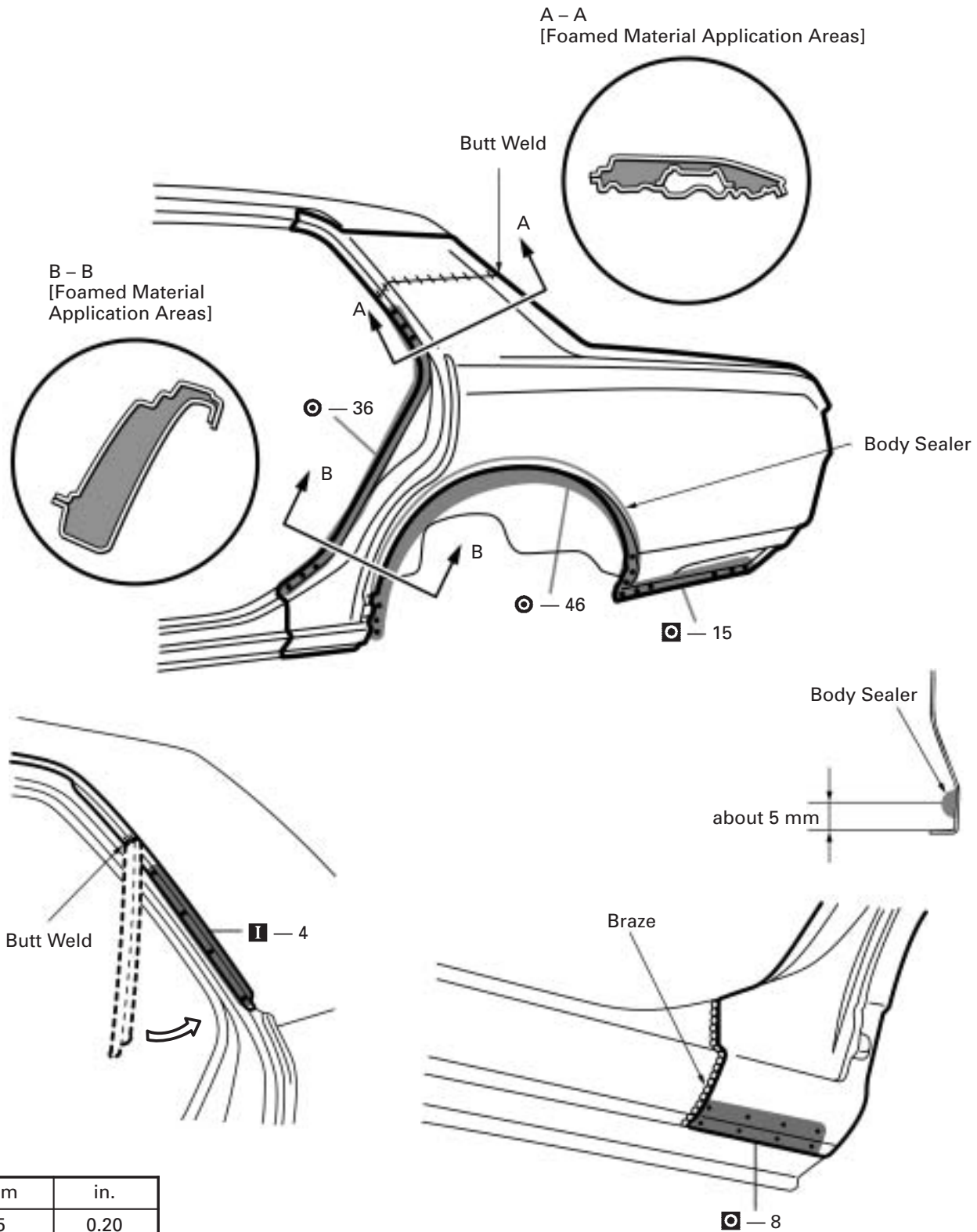

mm	in.
5	0.20

1. Before temporarily installing the new parts, apply body sealer to the wheel arch.

**HINT:**

- 1) Apply body sealer about 5 mm (0.20 in.) from the flange, avoiding any oozing.
- 2) Apply sealer evenly, about 3 - 4 mm (0.12 - 0.16 in.) in diameter.
- 3) For other sealing points refer to section AR.

2. Temporarily install the new parts and check the fit of the rear door, luggage compartment door and rear combination light.
3. After installing the new parts, apply foamed material.

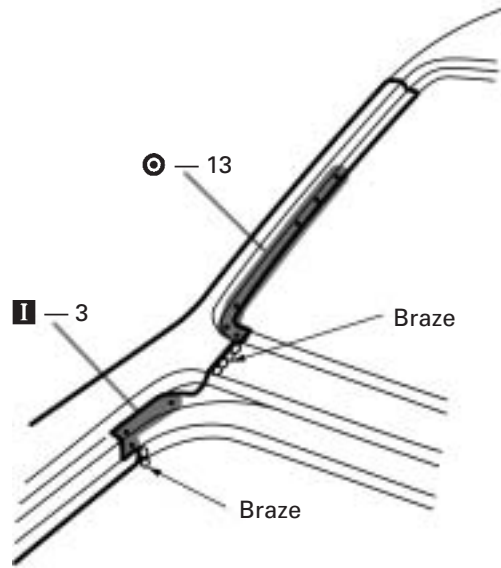

[It replacing the luggage compartment opening trough]

