

## REASSEMBLY

### HINT:

- Thoroughly clean all parts to be assembled.
- Before installing the parts, apply new fluid to all sliding and rotating surfaces.

### 1. MOUNT MOTOR HOUSING

Slightly mount the motor housing in a vise.

### NOTICE:

**Be careful not to damage the motor housing.**

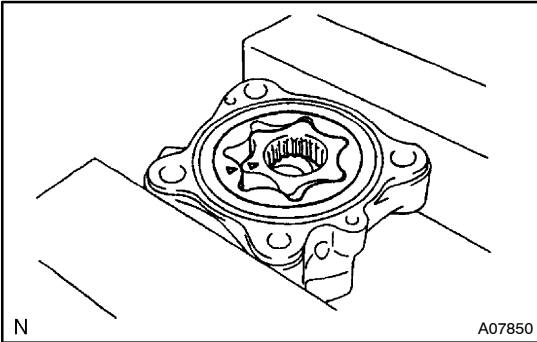

### 2. INSTALL DRIVEN AND DRIVE ROTORS

Install the drive and driven rotors with the dot mark facing upward.

### 3. INSTALL DRIVE SHAFT

### 4. INSTALL REAR PLATE WASHER

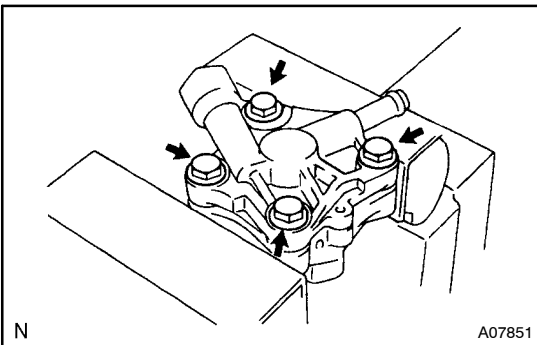

### 5. INSTALL MOTOR COVER

- Install a new O-ring to the motor housing groove.
- Install the motor cover with the 4 bolts.
- Tighten 4 bolts.

**Torque: 27 N·m (280 kgf·cm, 20 ft·lbf)**

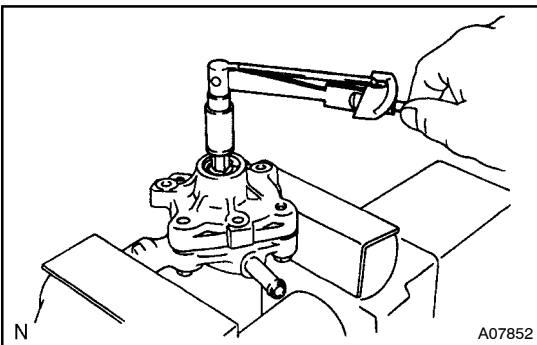

### 6. INSPECT DRIVE SHAFT PRELOAD

- Check that the drive shaft rotates smoothly without abnormal noise.
- Temporarily install the pulley nut, and check the rotating torque.

**Rotating torque:**

**0.1 N·m (1.0 kgf·cm, 0.9 in·lbf)**