

REMOVAL

1. **REMOVE INSTRUMENT PANEL UNDER COVER NO. 1, FINISH PLATE, INSTRUMENT PANEL PAD LOWER AND HEATER TO REGISTER DUCT NO. 2**
(See page BO-93)
2. **REMOVE PARKING BRAKE PEDAL ASSEMBLY**
 - (a) Disconnect the parking brake switch connector.
 - (b) Remove the 2 bolts, and disconnect the parking brake release lever from the safety pad.
Torque: 5.4 N·m (55 kgf·cm, 48 in·lbf)
 - (c) Remove the pin clip and pull out the pin from the parking brake cable.
 - (d) Remove the clip, and disconnect the parking brake cable.
 - (e) Remove the bolt, 3 nuts and parking brake pedal assembly.
Torque: 13 N·m (130 kgf·cm, 9 ft·lbf)
3. **REMOVE PARKING BRAKE SWITCH COVER AND SWITCH**
4. **DISCONNECT PARKING BRAKE RELEASE CABLE**
5. **REMOVE SHOCK ABSORBER**
 - (a) RHD:
Remove the 2 E-rings, 2 bushings and shock absorber.
 - (b) LHD:
Using screwdriver, remove the shock absorber and 2 cushions.
6. **REMOVE PARKING BRAKE PEDAL**
 - (a) RHD:
Using a snap ring pliers, remove the snap ring with snap ring pliers and remove the spacer.
 - (b) LHD:
Remove the nut and bolt.
Torque: 32 N·m (330 kgf·cm, 24 ft·lbf)
 - (c) RHD:
Remove the parking brake pedal and 2 bushings.
 - (d) LHD:
Remove the parking brake pedal, 2 bushings and collar.

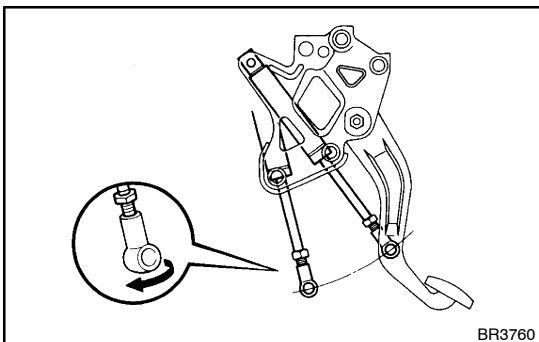

BR3760

7. **LHD:**
IF NECESSARY, ADJUST SHOCK ABSORBER
 - (a) Loosen the union lock nut.
 - (b) Install the shock absorber to the pin on the pedal bracket side, then extend the piston rod fully.
 - (c) Return the pedal until it hits the cushion.
 - (d) Make adjustments so that the shock absorber's union and the pin on the pedal side are aligned, then turn the union one turn counterclockwise.

- (e) Install the shock absorber to the pedal and torque the lock nut.

Torque: 13 N·m (130 kgf·cm, 9 ft·lbf)