

HOW TO USE THIS MANUAL

Each repair method description provided in Section RE of this manual comprises two pages, divided into 2 blocks (REMOVAL AND INSTALLATION) and includes illustrations to facilitate body repair.

RE-44 BODY PANEL REPLACEMENT

A **QUARTER PANEL (CUT)**

REMOVAL

[Cut and Join Location]

Arc Brazing

1. Cut and join the parts at the location as shown above.

HINT: Make incision and bend the roof drip channel at the upper part of the cut and join location.

mm	in.
200	7.87

A : **REPLACEMENT PARTS AND METHOD**

QUARTER PANEL (CUT)

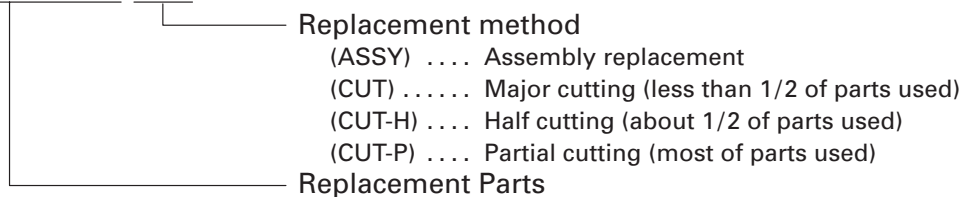

B : **PARTS LOCATION**

C : **REMOVAL DIAGRAM**

Describes in detail removal of the damaged parts involving repair by cutting.

D : **REMOVAL GUIDE**

Provides additional information to more efficiently help you perform the removal.

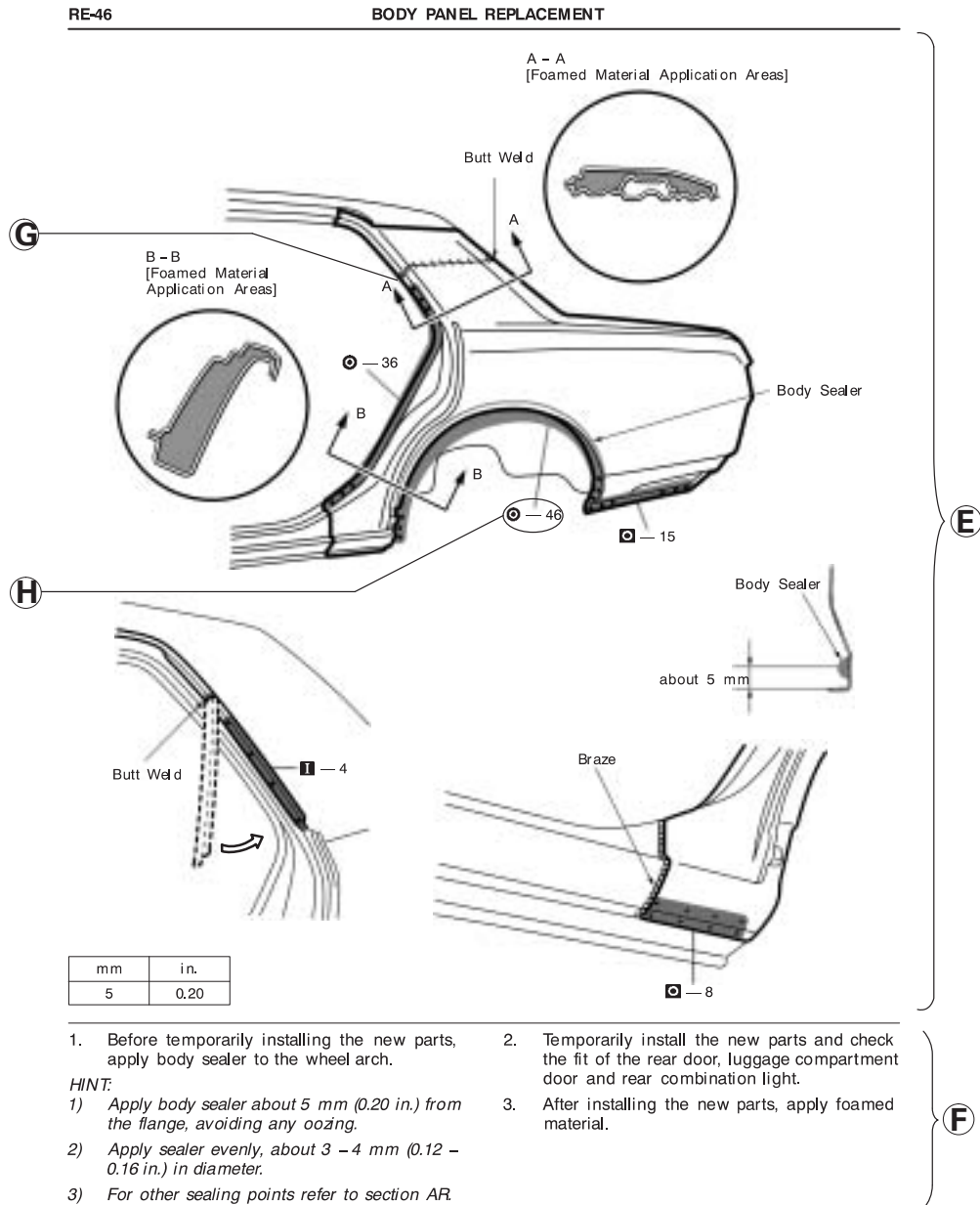

- E** : **INSTALLATION DIAGRAM**
Describes in detail installation of the new parts involving repair by welding and/or cutting, but excluding painting.
- F** : **INSTALLATION GUIDE**
Provides additional information to more efficiently help you perform the installation.
- G** : **SYMBOLS**
See page IN-4.
- H** : **ILLUSTRATION OF WELD POINTS**
Weld method and panel position symbols.
See page IN-5.