

REMOVAL

1. REMOVE NO. 1 CONSOLE BOX DUCT (See page BO-93)

- (a) Remove the shifting hole cover.
- (b) Remove the console upper cover.
- (c) Remove the front console box sub-assembly.
- (d) Remove the rear console armrest assembly.
- (e) Remove the console box register assembly.
- (f) Remove the box panel sub-assembly.
- (g) Remove the No. 3 console box duct.
- (h) Remove the console box sub-assembly.
- (i) Remove the No. 2 console box duct.
- (j) Remove the No. 1 console box duct.

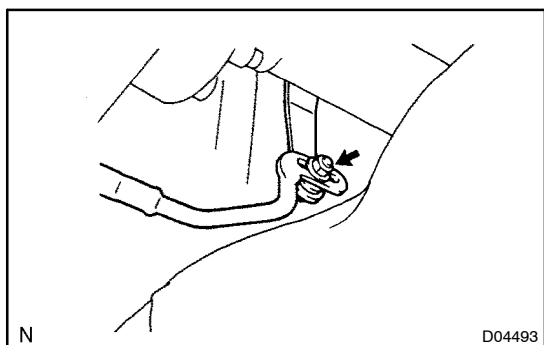

2. REMOVE FLOOR SHIFT ASSEMBLY

- (a) Remove the nut and floor shift assembly.

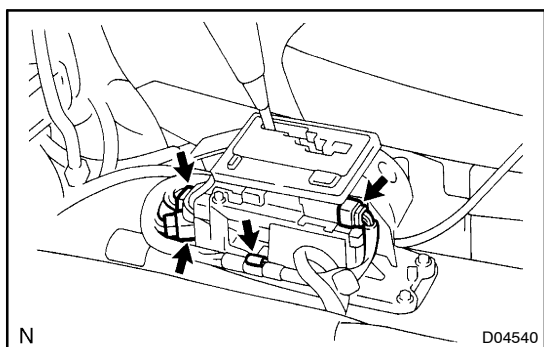

- (b) Disconnect the 3 connectors from the floor shift assembly.
- (c) Disconnect the clamp from the floor shift assembly.

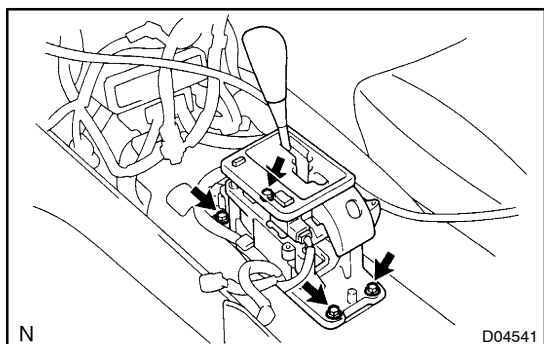

- (d) Remove the 4 bolts from the floor shift assembly.
- (e) Lift the floor shift assembly upward, then shift the shift lever in L range.